

**Dial indicators / Dial test indicators / Center instruments  
Edge finders / Probes / MF measuring fixture system**

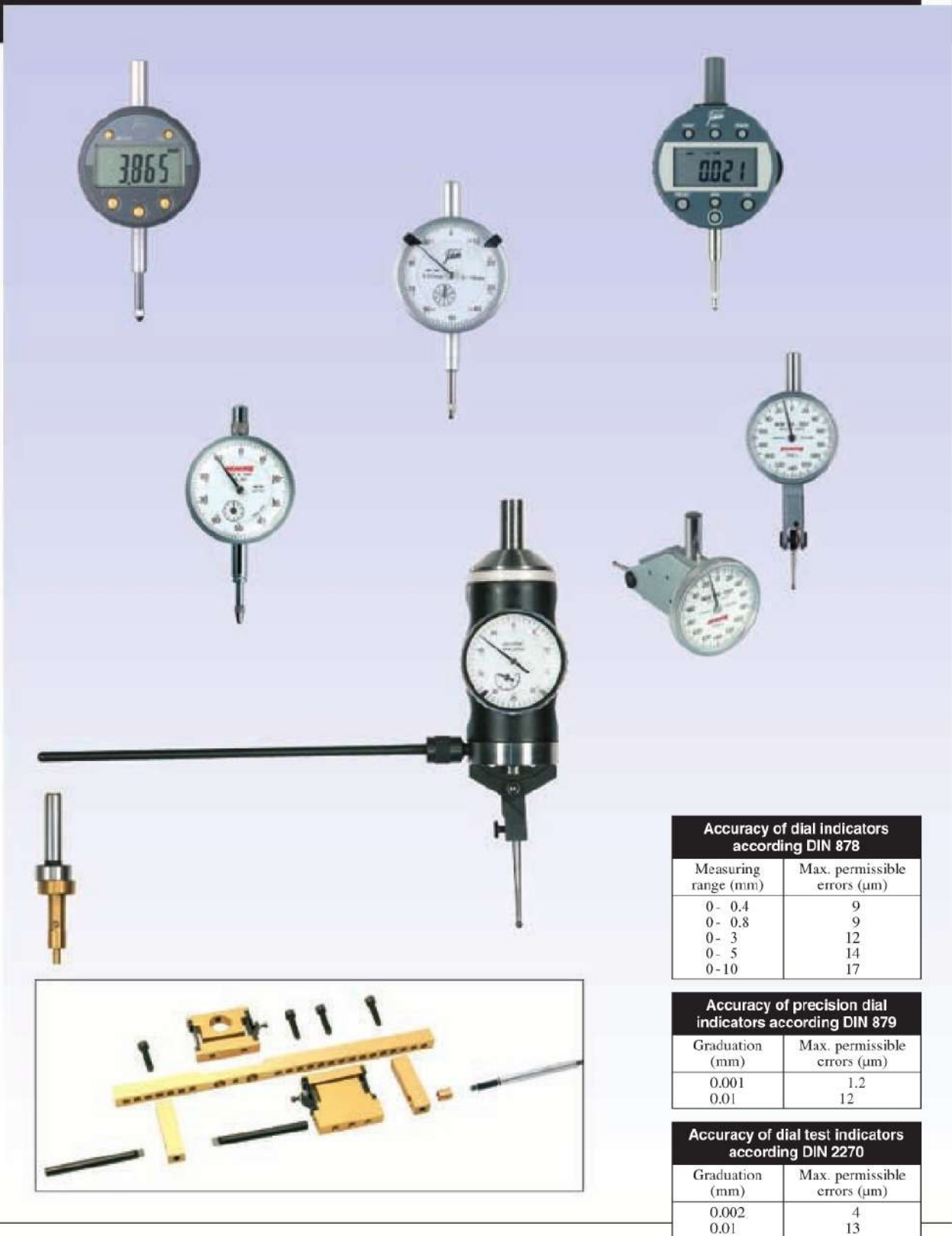

Accuracy of dial indicators according DIN 878	
Measuring range (mm)	Max. permissible errors (µm)
0 - 0.4	9
0 - 0.8	9
0 - 3	12
0 - 5	14
0-10	17

Accuracy of precision dial indicators according DIN 879	
Graduation (mm)	Max. permissible errors (µm)
0.001	1.2
0.01	12

Accuracy of dial test indicators according DIN 2270	
Graduation (mm)	Max. permissible errors (µm)
0.002	4
0.01	13

003.D01. Technobearing 201 (REV23)

## Digital dial indicators 0.01 and 0.001 mm

Digital dial indicators for a favourable price.

- Measuring range: 0-50 mm.
- Resolution: 0.01 or 0.001 mm.
- mm/inch conversion.
- ABS/INC switchable.
- On/off switch.
- Reset.
- Clamping stem:  $\varnothing$  8 mm.
- Dial diameter: 57 mm.
- Adjustable tolerance limits.
- Flat back and additional back with lug.
- Delivery with an inspection report.
- Power supply: 1 battery type CR2025.



TECHNOBEARING



Item No.	Measuring range/mm	Accuracy mm	Price RUB
<b>With resolution 0.01 mm:</b>			
907.634	0-12.5	$\pm 0.02$	
907.649	0-25	$\pm 0.03$	
907.652	0-50	$\pm 0.04$	
<b>With resolution 0.001 mm:</b>			
907.646	0-12.5	$\pm 0.015$	
<b>Options:</b>			
495.214	Spare battery		
909.446	USB interface		
909.687	Footswitch for USB interface		



- USB interface:**
- For data transfer to PC (e.g. Excel, Word).
  - Operating system: Windows and other.
  - PC connection: USB.
  - No software or driver to install.
  - Foot switch (optional).

## Absolute digital dial indicators

Absolute digital dial indicators with function to set tolerance limits with clear optical Go (NoGo) reading.

- Measuring range: 0-50 mm.
- Resolution: 0.01 mm or 0.001 mm.
- mm/inch conversion.
- ABS/INC switchable.
- With data output.
- Adjustable tolerance limits.
- **Tolerance display** by means of illuminated green LED at GO value.
- On/off switch.
- Reset/preset.
- Ceramic stylus tip.
- Max. measuring speed: unlimited.
- Clamping stem:  $\varnothing$  8 mm.
- Dial diameter: 60 mm.
- Reversible measuring direction.
- Flat back.
- With additional back with lug.
- Protection: IP54.
- Delivery in a case with an inspection report.
- Power supply: 1 battery type CR2032.

TECHNOBEARING

**NEW**



906.870



906.618

**USB interface:**  
 - For data transfer to PC (e.g. Excel, Word).  
 - Operating system: Windows and other.  
 - PC connection: USB.  
 - No software or driver to install.  
 - Foot switch (optional).



909.687

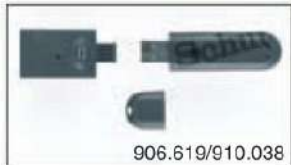

906.619/910.038

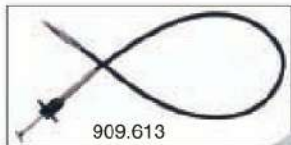

909.613



909.614

PRICE

Item No.	Measuring range/mm	Resolution mm	Accuracy mm	Price RUB
910.221	0-12.5	0.001	$\pm 0.004$	
910.222	0-25	0.001	$\pm 0.004$	
910.223	0-50	0.001	$\pm 0.005$	
906.870	0-12.5	0.01	$\pm 0.01$	
906.871	0-25	0.01	$\pm 0.01$	
906.872	0-50	0.01	$\pm 0.015$	

**Options:**

- 495.157 Spare battery
- 906.618 USB interface
- 909.687 Footswitch for USB interface
- 910.038 Wireless USB receiver
- 906.619 Wireless transmitter
- 909.611 Retraction lever
- 909.613 Cable retraction device (0.7 m) (maximum travel 10 mm)
- 909.614 Retraction lever (maximum travel 12.7 mm)

001.330 Technobearing 2019 04/2019

## Absolute digital dial indicators

- Measuring range: 0-50.8 mm.
- Resolution: 0.01 mm or 0.001 mm.
- mm/inch conversion.
- ABS/INC switchable.
- LCD display 330° rotatable.
- Digimatic data output.
- On/off switch.
- Reset/preset.
- Ceramic stylus tip.
- Max. measuring speed: unlimited.
- Measuring force: ≤ 2 N.
- Clamping stem: ø 8 mm.
- Dial diameter: 60 mm.
- Reversible measuring direction.
- With determination of the reversal point (only 910.004).

TECHNOBEARING

- Adjustable tolerance limits (except 910.004).
- Flat back.
- With additional back with lug (only 909.998, 910.001/004).
- Protection: IP54.
- Delivery in a case with an inspection report.
- Power supply: 1 battery type CR2032.



**USB interface:**

- For data transfer to PC (e.g. Excel, Word).
- Operating system: Windows and other.
- PC connection: USB.
- No software or driver to install.
- Foot switch (optional).

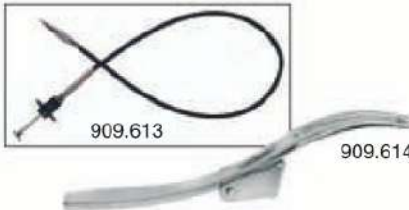

Item No.	Measuring range/mm	Resolution mm	Accuracy mm	Price RUB
909.998	0-12.7	0.001	±0.004	
909.999	0-25.4	0.001	±0.005	
910.000	0-50.8	0.001	±0.006	
910.001	0-12.7	0.01	±0.01	
910.002	0-25.4	0.01	±0.01	
910.003	0-50.8	0.01	±0.015	

**For internal measurements:**

910.004	0-12.7	0.001	±0.004
---------	--------	-------	--------

**With Bluetooth:**

910.079	0-12.7	0.001	±0.004
910.082	0-12.7	0.01	±0.01

**Options:**

- 495.157 Spare battery
- 909.686 USB interface
- 909.687 Footswitch for USB interface
- 910.038 Wireless USB receiver
- 910.039 Wireless transmitter
- 909.611 Retraction lever
- 909.613 Cable retraction device (0.7 m) (maximum travel 10 mm)
- 909.614 Retraction lever (maximum travel 12.7 mm)



### Digital dial indicators

Digital dial indicators with digital and digital-analog read-out.

- Measuring range: 0- 12.5 mm.
- Resolution: 0.002 or 0.001 mm.
- mm/inch conversion.
- ABS/INC switchable.
- On/off switch.
- Automatic switch-off.
- Reset/preset.
- Clamping stem:  $\varnothing$  8 mm.
- Dial diameter: 62 mm.
- Dial 360° rotatable.
- Reversible measuring direction.
- With determination of the reversal point.
- Adjustable tolerance limits.
- Power supply: 1 battery type CR2032.



Item No.	Measuring range/mm	Resolution mm	Accuracy mm	Measuring force/N	Price RUB
909.250	0- 12.5	0.002	$\pm 0.015$	1.8 - 3.0	
909.251	0- 12.5	0.001	$\pm 0.006$	2.2 - 3.5	
<b>Option:</b> 495.157 Spare battery					



### Digital dial indicators

Universal digital indicators with both digital and digital-analog display of the measuring value, and can also be rotated over 340° to ensure easy read-out in all positions.

- Measuring range: 0- 12.7 mm.
- Resolution: 0.001 mm.
- Analog resolution: 0.001/0.002/0.01/0.02/0.05 mm.
- mm/inch conversion.
- ABS/INC switchable.
- On/off switch.
- Automatic switch-off.
- Reset/preset.
- Clamping stem:  $\varnothing$  8 mm.
- Dial diameter: 61 mm.
- Dial 340° rotatable.
- Reversible measuring direction.
- Adjustable tolerance limits.
- Protection: IP54.
- Power supply: 1 battery type CR2032.



Item No.	Measuring range/mm	Accuracy mm	Price RUB
907.879	0- 12.7	$\pm 0.01$	
907.878	0- 12.7	$\pm 0.005$	
<b>Option:</b> 495.157 Spare battery			

TECHNOBEARING



### Absolute horizontal digital dial indicators

- Measuring range: 0-30 mm.
- Resolution: 0.001 mm.
- mm/inch conversion.
- Digimatic data output.
- On/off switch.
- Reset/preset.
- Ceramic stylus tip.
- With dovetail joint (incl. lug) and clamping stem  $\varnothing$ 8 mm.

- Measuring force:  $\leq$ 2 N.
- Reversible measuring direction.
- Protection: IP54.
- Delivery in a case with an inspection report.
- Power supply: 1 battery type CR1632.

*USB interface and wireless USB receiver and transmitter available on request.*



Item No.	Measuring range/mm	Resolution mm	Accuracy mm	Price RUB
910.085	0-12.7	0.001	$\pm$ 0.005	
910.086	0-30	0.001	$\pm$ 0.006	
<b>Option:</b> 497.955 Spare battery				

TECHNOBEARING

### Digital dial indicator with calculation function

Robust digital dial indicator with built-in calculation function for easy determination of diameters by means of measuring a curved surface. Suitable for measuring both inside and outside diameters and multifunctional dial indicator applications. Delivery with measuring bases of 10, 20, 30, 60 and 100 mm.

- Measuring range: 0-13 mm.
- Resolution: 0.005 mm.
- mm/inch conversion.
- On/off switch.
- Reset.

- Hold function.
- Clamping stem:  $\varnothing$ 8 mm.
- Aluminum construction.
- Delivery in a case.
- Power supply: 1 battery type CR2032.



Item No.	Measuring range/mm	Accuracy mm	Price RUB
907.884	0-13	$\pm$ 0.005*	
<b>Option:</b> 495.157 Spare battery			



\* Accuracy of the indicator without the use of measuring bases. The accuracy with measuring bases depends on the radius and form deviation of the workpiece.

001.029 Technobearing 201 (9625)

### Dial indicators 0.01 mm

Indicators with an excellent price-performance ratio.

- Measuring range: 0- 10 mm.
- Graduation: 0.01 mm.
- Clamping stem:  $\phi$  8 mm.
- Dial diameter: 55 mm.
- Rotatable dial.
- Shockproof.
- Adjustable tolerance markers.
- Flat back.
- Delivery with an inspection report.
- Retraction lever available on request (only 907.929/930).



Item No.	Measuring range/mm	Price RUB
907.928	0- 3	
907.929	0- 5	
907.930	0- 10	
<b>Option:</b>		
908.799	Back with lug	

### Dial indicators 0.01 mm

Indicators with a large dial and a locking screw. Shockproof design.

- Measuring range: 0- 10 mm.
- Graduation: 0.01 mm.
- Clamping stem:  $\phi$  8 mm.
- Dial diameter: 60 mm.
- Rotatable dial.
- Shockproof.
- Adjustable tolerance markers.
- Locking screw.
- Flat back.
- Delivery with an inspection report.

TECHNOBEARING

**NEW**



Item No.	Measuring range/mm	Price RUB
907.931	0- 3	
907.932	0- 5	
907.933	0- 10	
<b>Options:</b>		
908.987	Back with lug	
906.359	Retraction lever	



### Dial indicators 0.01 mm

Indicators with a large measuring range. Shockproof design.

- Measuring range: 0-100 mm.
- Graduation: 0.01 mm.
- Clamping stem:  $\varnothing$  8 mm.
- Rotatable dial.
- Shockproof.
- Adjustable tolerance markers (except 907.916).
- Locking screw.
- Flat back.
- Delivery with an inspection report.



Item No.	Measuring range/mm	Dial $\varnothing$ /mm	Price RUB
907.934	0- 25	60	
907.935	0- 30	60	
907.936	0- 50	76	
907.916	0-100	80	

**Options:**  
 908.987<sup>1</sup> Back with lug  
 908.988<sup>2</sup> Back with lug

<sup>1</sup> For 907.934/935.

<sup>2</sup> For 907.936/916.

### Splashproof dial indicators 0.01 mm

Indicators with splashproof design.

- Measuring range: 0-10 mm.
- Graduation: 0.01 mm.
- Clamping stem:  $\varnothing$  8 mm.
- Dial diameter: 55 mm.
- Rotatable dial.
- Shockproof.
- Adjustable tolerance markers.
- Locking screw.
- Back with lug.
- Protection: IP54.
- Conforms to factory standard.



Item No.	Measuring range/mm	Price RUB
908.777	0- 3	
908.778	0- 5	
908.779	0-10	

TECHNOBEARING

007\_003 Technobearing 201 (9628)



### Miniature dial indicators 0.01 and 0.001 mm

Indicators with very small dimensions and an excellent price-performance ratio. Shockproof design.

- Measuring range: 0-10 mm.
- Graduation: 0.01 or 0.001 mm.
- Clamping stem:  $\varnothing$  8 mm.
- Dial diameter: 40 mm.
- Rotatable dial.
- Shockproof.
- Adjustable tolerance markers.
- Locking screw.
- Flat back.
- Delivery with an inspection report.



Item No.	Measuring range/mm	Price RUB
<b>Graduation 0.01 mm:</b>		
907.925	0- 3	
907.926	0- 5	
907.927	0- 8	
907.914	0-10	
<b>Graduation 0.001 mm:</b>		
907.920	0- 1	
<b>Option:</b>		
908.986	Back with lug	



### Dial indicators 0.001 mm

Indicators with micrometer reading. Shockproof design.

- Measuring range: 0-5 mm.
- Graduation: 0.001 mm.
- Clamping stem:  $\varnothing$  8 mm.
- Dial diameter: 60 mm.
- Rotatable dial.
- Scale numbering: 0-100-0.
- Shockproof.
- Adjustable tolerance markers.
- Locking screw.
- Flat back.
- Delivery with an inspection report.



Item No.	Measuring range/mm	Price RUB
907.921	0-1	
907.922	0-2	
907.923	0-3	
907.924	0-5	
<b>Option:</b>		
908.987	Back with lug	



TECHNOBEARING

003.311. Technobearing 201 (9628)

**Peacock dial indicators 0.1 and 0.01 mm**

- Measuring range: 0-80 mm.
- Graduation: 0.1 or 0.01 mm.
- Clamping stem:  $\varnothing$ 8, 10 or 14 mm.
- Rotatable dial.
- Adjustable tolerance markers.
- Flat back or back with lug\*.
- DIN 878.
- Delivery in a case.

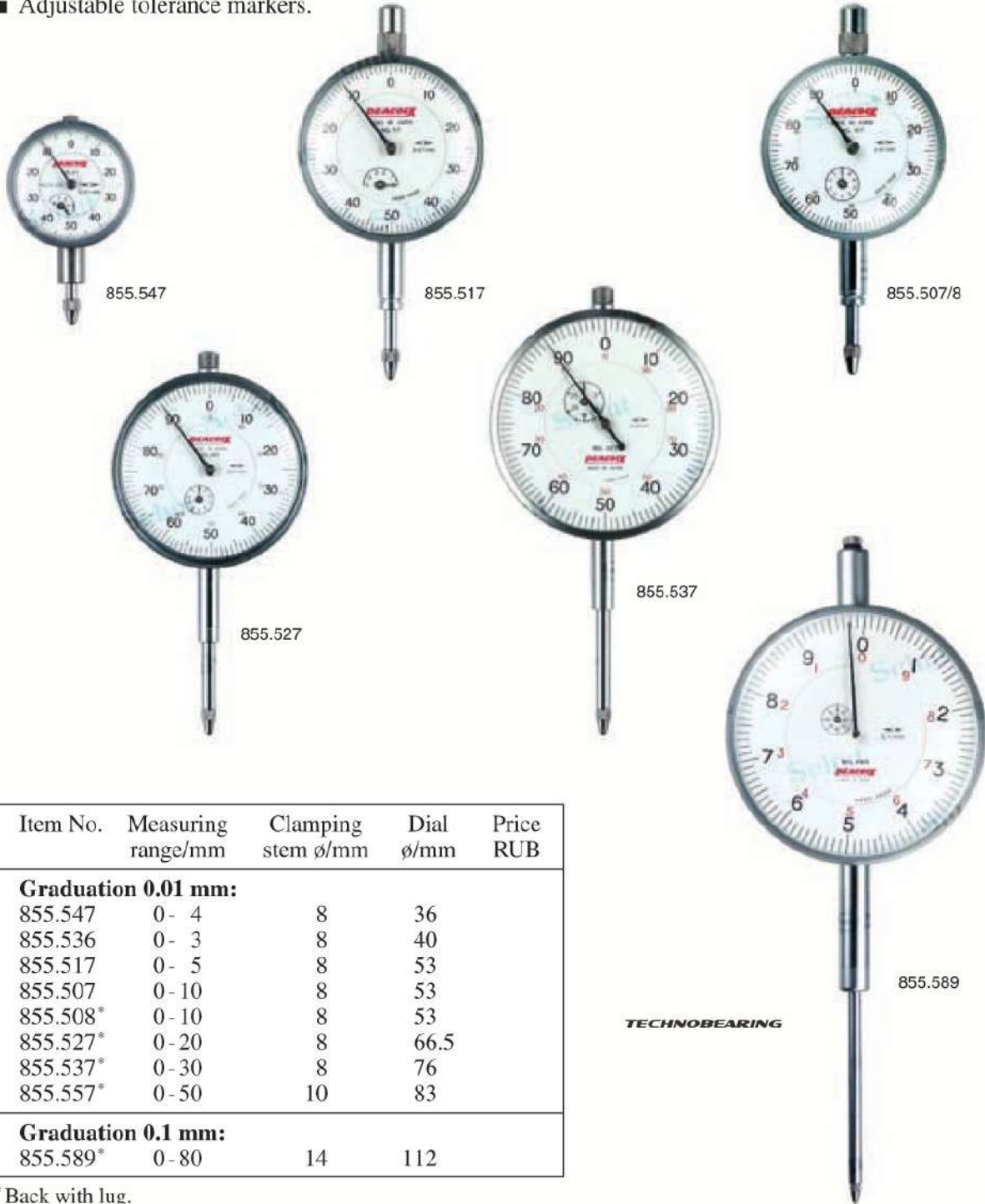

Item No.	Measuring range/mm	Clamping stem $\varnothing$ /mm	Dial $\varnothing$ /mm	Price RUB
<b>Graduation 0.01 mm:</b>				
855.547	0 - 4	8	36	
855.536	0 - 3	8	40	
855.517	0 - 5	8	53	
855.507	0 - 10	8	53	
855.508*	0 - 10	8	53	
855.527*	0 - 20	8	66.5	
855.537*	0 - 30	8	76	
855.557*	0 - 50	10	83	
<b>Graduation 0.1 mm:</b>				
855.589*	0 - 80	14	112	

\* Back with lug.

**Peacock dial indicators 0.005 and 0.001 mm**

- Measuring range: 0-5 mm.
- Graduation: 0.005 or 0.001 mm.
- Clamping stem:  $\varnothing 8$  mm.
- Rotatable dial.
- Flat back or back with lug\*.
- DIN 878.
- Delivery in a case.

Item No.	Measuring range/mm	Dial $\varnothing$ /mm	Price RUB
<b>Graduation 0.005 mm:</b>			
855.535*	0-3	47	
<b>Graduation 0.001 mm:</b>			
855.509	0-1	53	
855.525*	0-2	66.5	
855.555*	0-5	66.5	

\* Back with lug.

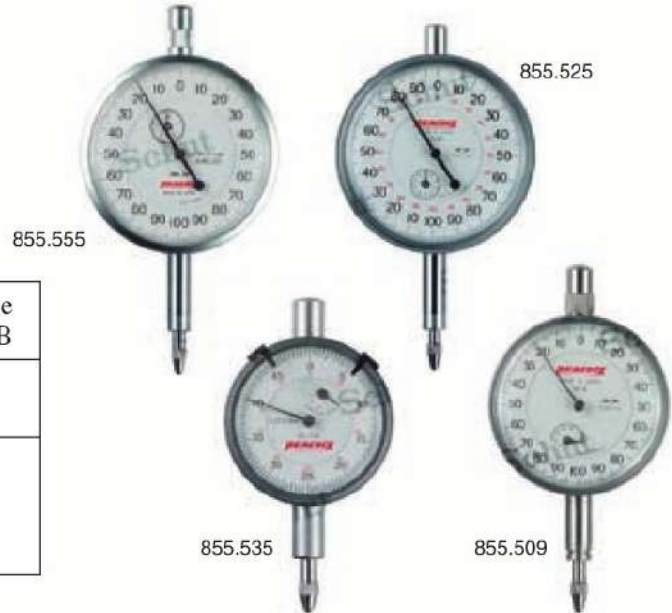

**Peacock dial indicators with back plunger**

The back plunger dial indicator is characterized with easy handling since the spindle with the contact point is moving in the direction perpendicular to the dial face and the gauge is more compact. The dial indicator of this type is convenient for use in achieving a parallelism of the table of the machine tool, with measuring jigs, in restricted areas and on locations where scale reading is difficult.

- Measuring range: 0-5 mm.
- Graduation: 0.01 mm.
- Repeatability: 0.005 mm.
- Hysteresis:  $\pm 0.006$  mm.
- Measuring force: 1.4 N.
- Rotatable dial.
- Scale numbering: 0-100.
- DIN 878.
- Delivery in a case.

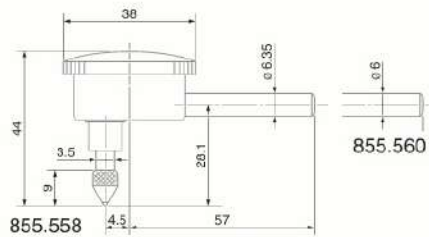

Item No.	Measuring range/mm	Clamping stem $\varnothing$ /mm	Accuracy mm	Price RUB
855.558	0-5	6.35	$\pm 0.02$	
855.560	0-5	6	$\pm 0.02$	
<b>Clamping stem on back side:</b>				
855.559	0-5	8	$\pm 0.02$	

### Precision dial indicator

Highly accurate shockproof dial indicator for measurements from a fixed reference point. Very suitable for internal measuring instruments and dial indicator stands for example.

- Measuring range: 0.1 mm.
- Graduation: 0.001 mm.
- Measuring force: < 2 N.
- Clamping stem:  $\varnothing$  8 mm.
- Travel: 3 mm.
- Adjustable tolerance markers.
- Fine adjustment.
- Delivery with an inspection report.



TECHNOBEARING

Item No.	Measuring range/mm	Dial $\varnothing$ /mm	Price RUB
907.939	0.1	63.5	

### Precision dial indicators

- Measuring range: 0.06 mm.
- Graduation: 0.0005 mm or 0.001 mm.
- Measuring force: approx. 1 N.
- Clamping stem:  $\varnothing$  28 mm.
- Shockproof.
- Fine adjustment.
- Delivery with an inspection report.



906.333

Item No.	Measuring range/mm	Resolution mm	Scale numbering	Price RUB
906.332	0.03	0.0005	15-0-15	
906.333	0.06	0.001	30-0-30	

003.215 Technobearing 201 (90623)

**Inserts**

Inserts with thread M2.5. The inserts are made of steel unless otherwise indicated; tungsten carbide (TC), ruby (R) or sapphire (S).

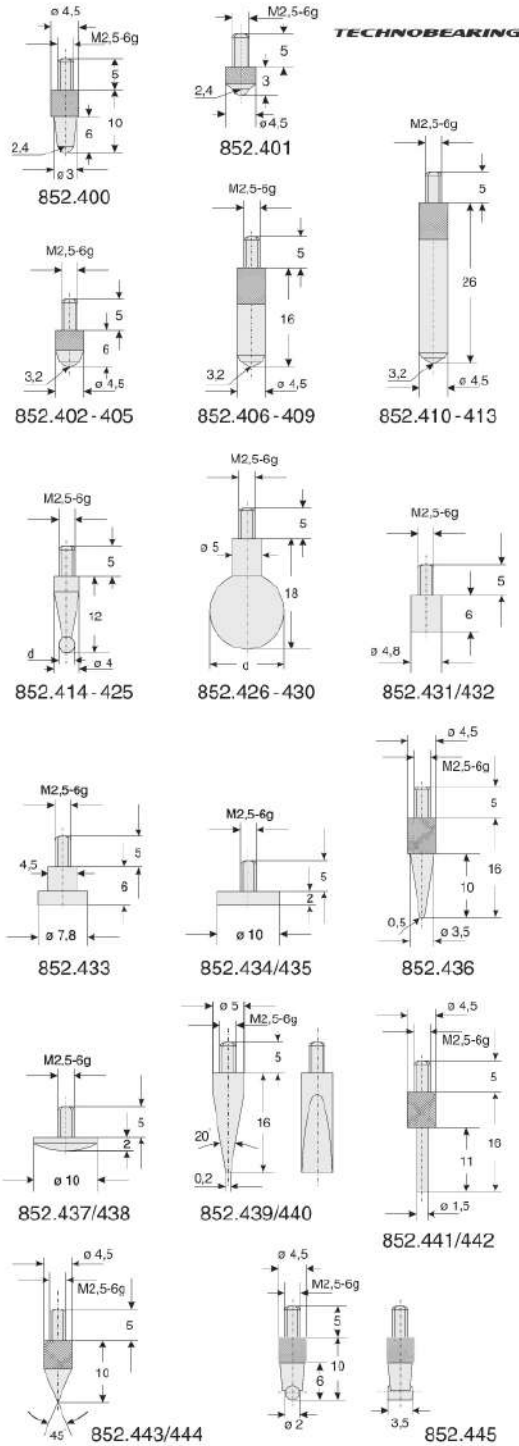

Item No.	Description	Price RUB
<b>Ball probes:</b>		
852.400	d= 2.4 mm l= 10 mm	
852.401	d= 2.4 mm l= 3.0 mm	
852.402	d= 3.2 mm l= 6.0 mm	
852.403	d= 3.2 mm l= 6.0 mm	TC
852.404	d= 3.2 mm l= 6.0 mm	R
852.405	d= 3.2 mm l= 6.0 mm	S
852.406	d= 3.2 mm l= 16 mm	
852.407	d= 3.2 mm l= 16 mm	TC
852.408	d= 3.2 mm l= 16 mm	R
852.409	d= 3.2 mm l= 16 mm	S
852.410	d= 3.2 mm l= 26 mm	
852.411	d= 3.2 mm l= 26 mm	TC
852.412	d= 3.2 mm l= 26 mm	R
852.413	d= 3.2 mm l= 26 mm	S
852.420	d= 1.0 mm l= 12 mm	TC
852.415	d= 2.0 mm l= 12 mm	
852.421	d= 2.0 mm l= 12 mm	TC
852.416	d= 3.0 mm l= 12 mm	
852.422	d= 3.0 mm l= 12 mm	TC
852.417	d= 4.0 mm l= 12 mm	
852.423	d= 4.0 mm l= 12 mm	TC
852.418	d= 5.0 mm l= 12 mm	
852.424	d= 5.0 mm l= 12 mm	TC
852.419	d= 6.0 mm l= 12 mm	
852.425	d= 6.0 mm l= 12 mm	TC
852.426	d= 7.0 mm l= 18 mm	
852.427	d= 8.0 mm l= 18 mm	
852.428	d= 9.0 mm l= 18 mm	
852.429	d= 10.0 mm l= 18 mm	
852.430	d= 11.0 mm l= 18 mm	
<b>Flat probes:</b>		
852.431	d= 4.8 mm l= 6 mm	
852.432	d= 4.8 mm l= 6 mm	TC
852.433	d= 7.8 mm l= 6 mm	
852.434	d= 10.0 mm l= 2 mm	
852.435	d= 10.0 mm l= 2 mm	TC
<b>Spherical probes:</b>		
852.436	conical l= 16 mm	
852.437	d= 10.0 mm l= 2.0 mm	
852.438	d= 10.0 mm l= 2.0 mm	TC
<b>Knife-edged probes:</b>		
852.439	d= 5.0 mm l= 16 mm	
852.440	d= 5.0 mm l= 16 mm	TC
<b>Needle-shaped probes:</b>		
852.441	d= 1.5 mm l= 16 mm	
852.442	d= 1.5 mm l= 16 mm	TC
<b>Tapered probes:</b>		
852.443	d= 4.5 mm l= 10 mm point 45°	
852.444	d= 4.5 mm l= 10 mm point 45°	TC
<b>Probe with cylindrical measuring face:</b>		
852.445	d= 2 x 3.5 mm l= 10 mm	

003.231. Technobearing 201 (9625)

## Extensions for inserts

Steel extensions for inserts with thread M2.5.

Item No.	Length mm	Price RUB
<b>Extensions with <math>\Lambda = \phi 4</math> mm:</b>		
852.446	10	
852.447	15	
852.448	20	
852.449	25	
852.450	30	
852.451	35	
852.452	40	
852.453	45	
852.454	50	
852.455	55	
852.456	60	
852.457	65	
852.458	70	
852.459	75	
852.460	80	
852.461	85	
852.462	90	
852.463	95	
852.464	100	

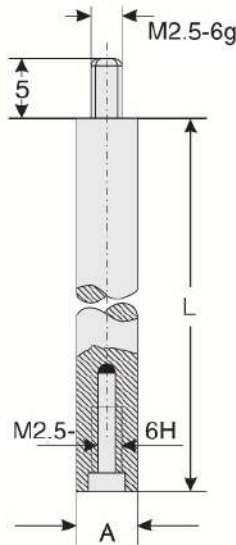

Item No.	Length mm	Price RUB
<b>Extensions with <math>\Lambda = \phi 5</math> mm:</b>		
852.465	10	
852.466	15	
852.467	20	
852.468	25	
852.469	30	
852.470	35	
852.471	40	
852.472	45	
852.473	50	
852.474	55	
852.475	60	
852.476	65	
852.477	70	
852.478	75	
852.479	80	
852.480	85	
852.481	90	
852.482	95	
852.483	100	

## Adapters for inserts

Adapter for attaching other inserts to dial indicators and probes with an interchangeable insert with thread M2.5.

Item No.	External/internal thread	Price RUB
960.276	M2.5/M2	

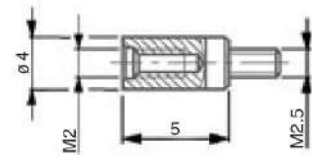

## Depth measuring bases for dial indicators

Bases which make dial indicators and probes suitable for depth measurements.

- Clamping shaft: 8H7.

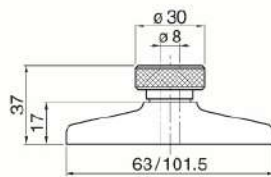
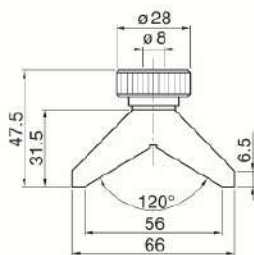

907.153



906.644

**NEW**

TECHNOBEARING



PRICE

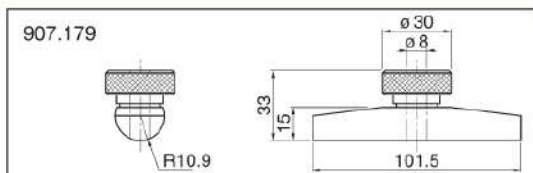

907.179

Item No.	Measuring face l x w/mm	Price RUB
907.153	63 x 17	
907.165	101.5 x 17	
906.644	66 x 16	
<b>With cylindrical measuring face:</b>		
907.179	101.5 x R10.9	

**Clamping bush**



Item No.	Description	Price RUB
780.398	Clamping bush VKE	
780.397	Clamping screw VKD	

**Swivel-type probe**

Swivel-type probe for dial indicators with M2.5 thread. The probe can be oriented over 180°. Equipped with a steel ball probe ø 3 mm.

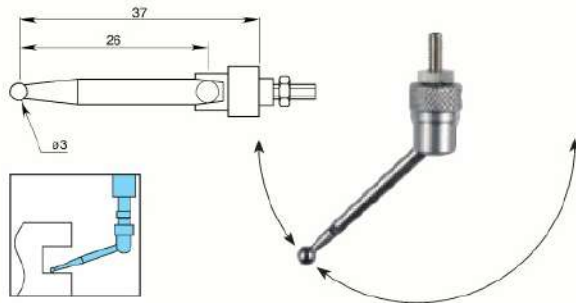

Item No.	Description	Price RUB
900.391	Swivel-type probe	

**Angle probe and special probe**

Probes e.g. for checks and alignments of bores on lathes.

- Probe measuring range: 10 mm.
- Measuring depth: 30 mm (856.149) or 60 mm (856.150).
- Clamping stem: ø 8 mm.
- Clamping shaft: ø 8 mm.



Item No.	Description	Price RUB
856.149	Angle probe	
856.150	Special probe	

**Clamping bush**

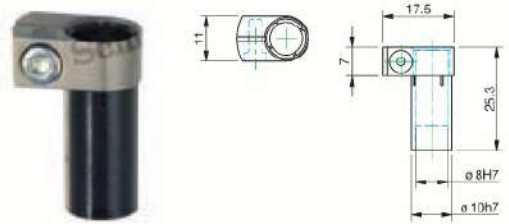

Item No.	Description	Price RUB
906.497	Clamping bush	

**Angle probe**

Angle probe used for the transmission of the plunger movements up to 10 mm. Suited for dial indicators with a 0.01 mm graduation. Delivery incl. flat insert ø 5 mm.

- Probe measuring range: 10 mm.
- Clamping shaft: ø 8 mm.



Item No.	Description	Price RUB
782.440	Angle probe	

**Probe holder**

Probe holder for for surfacemounting.

- Clamping shaft: ø 8 mm.
- For attaching with M4 bolts.
- Material: anodized aluminum.

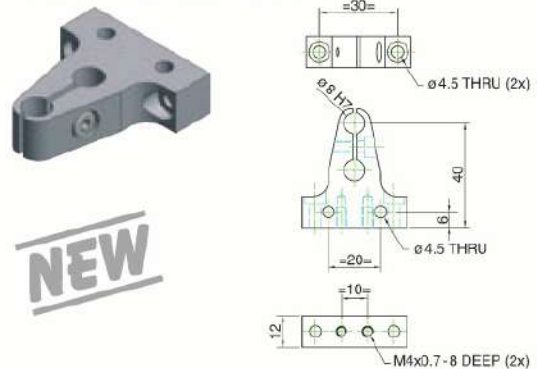

Item No.	Description	Price RUB
993.054	Probe holder	

**Lever-type test indicators**

- Measuring range: up to 0.8 mm.
- Graduation: 0.01 or 0.002 mm.
- With dovetail joint and clamping stems  $\varnothing 6$  and  $\varnothing 8$  mm.
- Dial diameter: 40 mm.

- Rotatable dial.
- Stylus tip:  $\varnothing 2$  mm.
- Delivery with an inspection report.

**NEW**



907.941

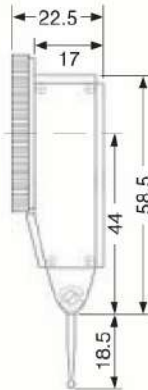

907.942

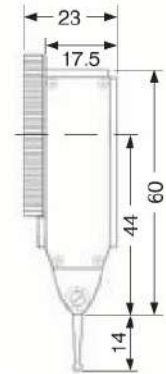

Item No.	Measuring range/mm	Graduation mm	Scale numbering	Insert length/mm	Price RUB
907.941	0.8	0.01	0-40-0	19	
907.942	0.2	0.002	0-100-0	13	

**Options:**

- 909.114 Steel spare stylus tip for 907.941
- 909.115 Steel spare stylus tip for 907.942
- 906.663 Ruby spare stylus tip for 907.941
- 906.664 Ruby spare stylus tip for 907.942



909.114/115



906.663/664



Clamping stem  $\varnothing 6/\varnothing 8$  mm.

TECHNOBEARING

**Lever-type digital test indicator**

Lever-type digital test indicator with tolerance judgement. Suitable for measurements in both directions. Equipped with three dovetail mountings.

- Measuring range: up to 0.5 mm.
- Resolution: 0.001 mm.
- Accuracy:  $\pm 0.02$  mm.
- mm/inch conversion.
- On/off switch.
- Reset.
- Measuring force:  $\leq 0.6$  N.
- With dovetail joint and clamping stems  $\varnothing 6$  and  $\varnothing 8$  mm.
- Ruby stylus tip:  $\varnothing 2$  mm.



- 230° adjustable measuring insert.
- Adjustable tolerance limits.
- Power supply: 1 battery type V357.



Item No.	Measuring range/mm	Resolution mm	Insert length/mm	Price RUB
907.574	0.5	0.001	17	

**Options:**

- 836.535 Spare battery
- 907.769 Spare stylus tip



## Peacock lever-type dial test indicators

- Measuring range: up to 1 mm.
- Graduation: 0.01, 0.002 or 0.001 mm.
- With dovetail joint and clamping stem  $\varnothing 6$  mm.
- Measuring force:  $< 0.3$  N (except 855.610: 0.05 N).
- Tungsten carbide stylus tip:  $\varnothing 2$  mm.
- Insert thread: M1.7.

### Inserts for lever-type dial test indicators

Item No.	Effective length (EL)/mm	Ball $\varnothing$ /mm	Price RUB
<b>For 855.601, 855.605 and 855.610:</b>			
859.016	17.74	2	
859.152	17.74	1	
859.151	17.74	0.8	
859.290	17.74	0.5	
<b>For 855.602:</b>			
859.126	39.00	2	
859.291	39.00	1	
859.292	39.00	0.8	
859.293	39.00	0.5	
<b>For 855.603 and 855.606:</b>			
859.200	14.33	2	
859.294	14.33	1	
859.295	14.33	0.8	
859.296	14.33	0.5	
<b>For 855.604:</b>			
859.259	8.13	2	
859.297	8.13	1	
859.298	8.13	0.8	
859.299	8.13	0.5	
<b>For 855.611:</b>			
859.464	19.24	2	
859.465	19.24	1	
859.466	19.24	0.8	
859.467	19.24	0.5	



Item No.	Measuring range/mm	Graduation mm	Dial $\varnothing$ /mm	Scale numbering	Insert	Total insert length (TL)/mm	Price RUB
<b>Horizontal:</b>							
855.601	0.5	0.01	35	0-25-0	859.016	21.3	
855.602	1	0.01	35	0-50-0	859.126	42.8	
855.603	0.28	0.002	35	0-140-0	859.200	17.9	
855.604	0.14	0.001	35	0-70-0	859.259	11.7	
855.611	0.8	0.01	35	0-40-0	859.464	22.4	
855.610	0.5	0.01	35	0-25-0	859.016	21.3	
<b>Perpendicular:</b>							
855.605	0.5	0.01	35	0-25-0	859.200	21.3	
855.606	0.28	0.002	35	0-140-0	859.200	17.9	

**Accessories dial indicators/dial test indicators**

Item No.	Description	Price RUB
909.433	Centering support $\varnothing 8 \times 25$ mm, holder $\varnothing 4$ mm	
909.434	Rectangular fixing shaft $12 \times 6 \times 76$ mm, holder $\varnothing 4/\varnothing 8$ mm and dovetail clamp	
909.435	Rectangular fixing shaft $12 \times 6 \times 76$ mm, holder $\varnothing 6/\varnothing 8$ mm and dovetail clamp	
909.436	Rectangular fixing shaft $9 \times 9 \times 76$ mm, holder $\varnothing 4/\varnothing 8$ mm and dovetail clamp	
909.437	Rectangular fixing shaft $9 \times 9 \times 76$ mm, holder $\varnothing 6/\varnothing 8$ mm and dovetail clamp	
909.438	Round, swivelling fixing shaft $\varnothing 6 \times 70$ mm, holder with dovetail clamp	
909.439	Round, swivelling fixing shaft $\varnothing 8 \times 70$ mm, holder with dovetail clamp	



**Reducer**



TECHNOBEARING

837.190

Item No.	Thread	Price RUB
781.819	$\varnothing 8 \rightarrow 4$ mm	
837.190	$\varnothing 8 \rightarrow 6$ mm	

**Center-accessory**

Small magnetic dial indicator stand which, in combination with a lever, could also be used as center-accessory to align bores in workpieces. For use in combination with a machine center.

- Permanent magnet  $\varnothing 27$  mm.
- Universal pivot with dovetail clamp.
- Delivery incl. cylindrical support  $\varnothing 9.5$  mm for insert in the collet chuck of a machine center.



Item No.	Description	Price RUB
781.997	Center-accessory	

003.315 Technobearing 201 (9623)

### Centering device

Convenient tool to find and set up the position of a workpiece on vertical and horizontal machines. It can also be used to determine the position of a workpiece when the spindle is rotated by hand or automatic. Easy read-out from stationary dial indicator. Instrument with compact dimensions.

- Max. range of use: 300 mm.
- Scale read-out per rotation: 0-3 mm.
- Graduation: 0.01 mm.
- Centering inside and outside with various probes.
- 3 straight and 3 bended probes included.
- Center feeler included.
- Spindle rotating speed max. 800 rpm.
- Compact dimensions.
- For horizontal and vertical use suitable.
- Clamping stem:  $\phi$  10 mm.
- Delivery in a case.

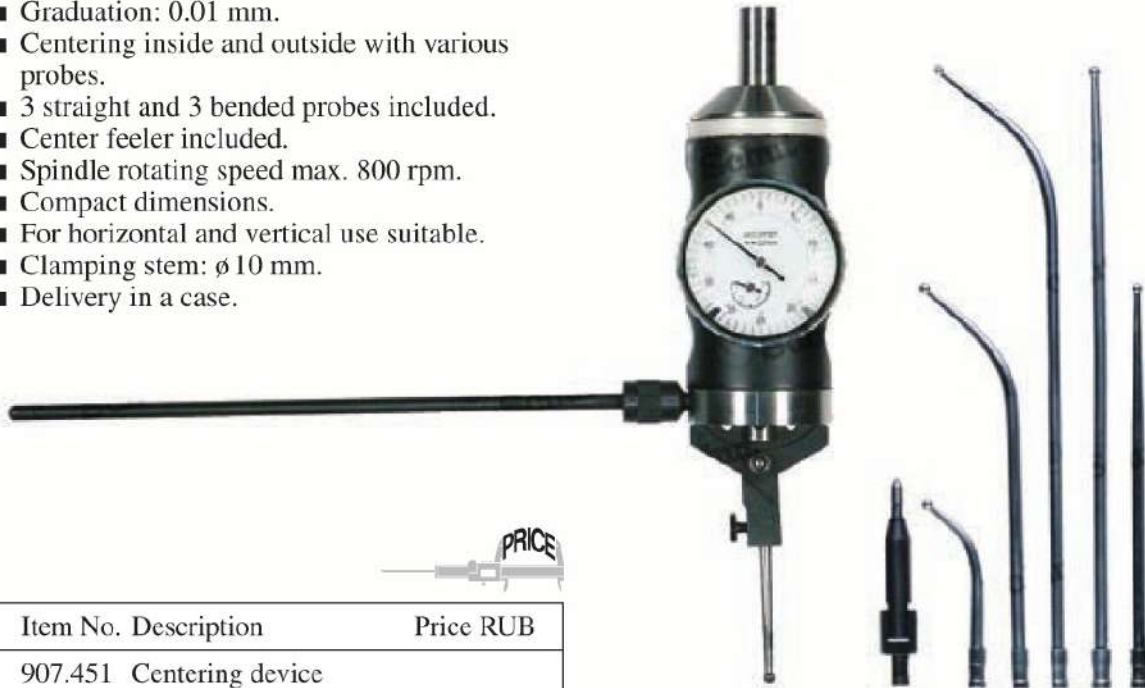

Item No.	Description	Price RUB
907.451	Centering device	
<b>Option:</b>		
907.445	Probe set (7 pieces)	

### Edge finders

Edge finders for both stationary and rotating use. As soon as the workpiece is touched by the ballprobe the all around visible LED will light up due to galvanic contact. The ballprobe is held in place by a spring. When the pressure on the tip becomes too large the ball will flip away sideways. The edge finders are also available with additional sound signal for extra working comfort.

- Concentricity:  $<0.01$  mm.
- Diameter ballprobe: 10 mm.
- Delivery in a case.
- Power supply:  
907.456/460: 2 batteries type V357,  
907.454/458: 1 battery type 23A.



Item No.	Clamping stem $\phi$ /mm	Length mm	Price RUB
907.454	20	162	
907.456	20	100	
<b>With sound signal:</b>			
907.458	20	162	
907.460	20	100	
<b>Options:</b>			
836.535	Spare battery (2 needed)		
497.931	Spare battery		

TECHNOBEARING

907.456

907.458

### 3D probes for centering and measuring

For easy and with high accurate setting the reference point of workpiece in all three axes (X, Y and Z), vertically and horizontally.

- Measuring range: max. ±2 mm (rupture point in probe).
- Analog: graduation 0.01 mm, digital: resolution 0.001 mm.
- Clamping stem:  $\varnothing 20$  mm.
- Insert length 25 mm, stylus tip  $\varnothing 4$  mm (insert length 65 mm and diameter 8 mm optional).
- mm/inch conversion (only 853.822).
- Digit height: 8.5 mm (only 853.822).
- Isolation between insert and insert thread; for use on all machining centres and EDM machines.
- Insert thread: M3.
- Protection:  
analog: IP67,  
digital: IP64.

TECHNOBEARING



Item No.	Description	Accuracy mm	Repeatability mm	Price RUB
853.821	Analog 3D probe	±0.01	0.01	
853.822	Digital 3D probe	±0.005	0.001	
<b>Options:</b>				
495.157	Spare battery			
853.823	Spare insert 25 mm, tip diameter 4 mm			
853.824	Spare insert 65 mm, tip diameter 8 mm			

### Edge finders

Rotating edge finders for accurate edge location.

- Resolution: 0.005 mm.
- Repeatability: 0.005 mm.
- Range of use: 400-600 rpm.
- Hardness TiN measuring face: 2200 HV.



Item No.	Clamping stem $\varnothing$ /mm	Probe $\varnothing$ /mm	Material (measuring face)	Price RUB
909.360	8	10	steel	
909.361	10	10	steel	
909.362	8	4 and 10	steel	
909.363	10	4 and 10	steel	
909.364	6	6	steel	
909.365	10	10	steel + ceramic	
909.366	10	10	steel + TiN	
909.367	10	4 and 10	steel + TiN	
<b>Options:</b>				
909.368	Spring for 909.360/362			
909.369	Spring for 909.364			
909.359	Spring for 909.365			
909.349	Spring for 909.361/363/366/367			

003.317. Technobearing 201 (9628)

**Z-axis setting gauge**

For easy presetting the Z-axis with a tool, with or without in combination with parallel blocks to set a specific height. As soon as the tool touches the setting gauge (with floating top) the built-in red LED illumination will light up. After this the axis will move in opposite direction until the lamp turns off, this is the turning point, and so the setting gauge, to determine the accuracy.

- Repeatability: 0.01 mm.
- With magnetic base.
- Galvanic contact principle.



- Dimensions:  $\varnothing 54 \times 50$  mm (precise height to determine with external measuring instrument).
- Weight: 450 g.
- Power supply: 2 batteries type V389.



Item No.	Description	Price RUB
908.804	Z-axis setting gauge	
<b>Option:</b>		
498.823	Spare battery (2 needed)	

**Digital Z-axis setting gauge**

For easy presetting the Z-axis with a tool, with or without in combination with parallel blocks to set a specific height.

- Graduation: 0.01 mm.
- Repeatability: 0.01 mm.
- With magnetic base.
- mm/inch conversion.



- On/off switch.
- Automatic switch-off.
- Height: 50 mm (precise height to determine with external measuring instrument).
- Weight: 377 g.
- Power supply: 1 battery type V357.
- Delivery with reference pin for insert in tool holder.

Item No.	Description	Price RUB
910.169	Z-axis setting gauge	
<b>Option:</b>		
836.535	Spare battery	

**Z-axis setting gauge**

For easy presetting the Z-axis with a tool, with or without in combination with parallel blocks to set a specific height.

- Graduation: 0.01 mm.
- Repeatability: 0.02 mm.
- With magnetic base.
- Diameter dial indicator:  $\varnothing 35$  mm.



TECHNOBEARING

- Height: 50 mm (precise height to determine with external measuring instrument).
- Weight: 1013 g.
- Delivery with reference pin for insert in tool holder.



Item No.	Description	Price RUB
909.460	Z-axis setting gauge	

001.324 Technobearing 201 (9623)