

тип 3F

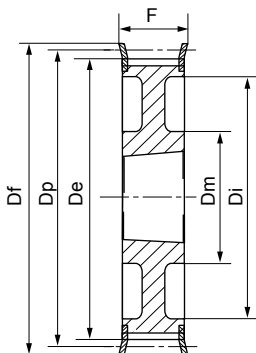

тип 3WF

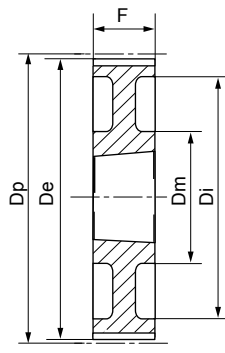

тип 3W

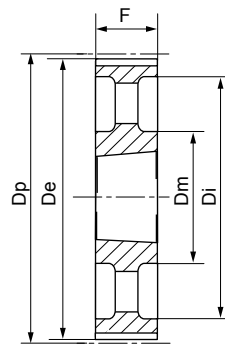

тип 3A

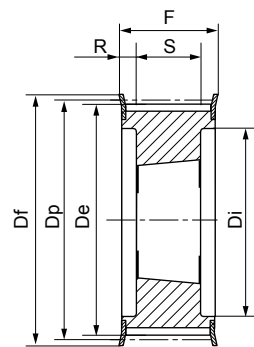

тип 4F

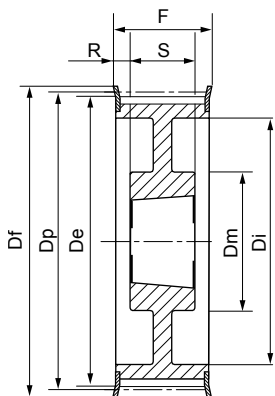

тип 4WF

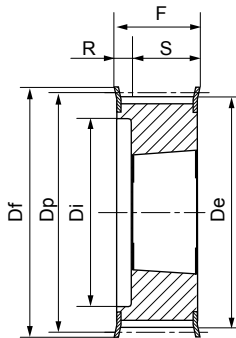

тип 5F

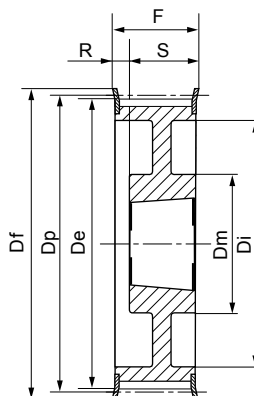

тип 5WF

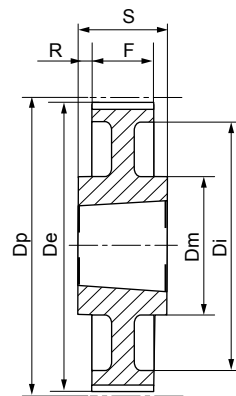

тип 7W

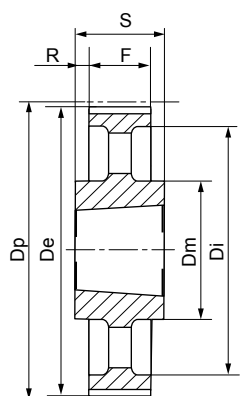

тип 7A

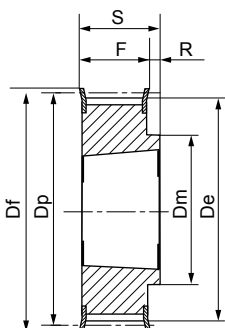

тип 8F

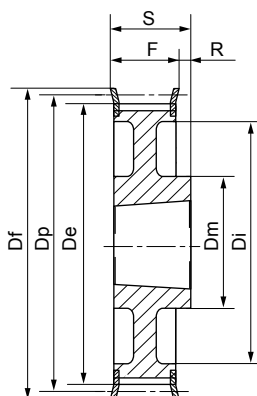

тип 8WF

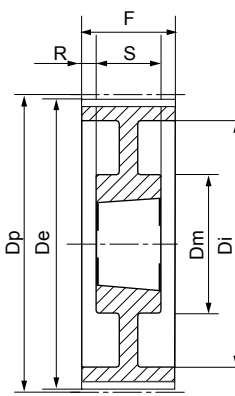

тип 9W

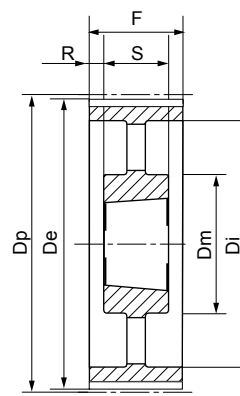

тип 9A

L 075 – 3/8" (9,525 мм)

Характеристики	Обозначение	КОД	Тип шкива	Типо-размер реборды	Втулка тапербуш	Диаметр максим. отверстия, мм	Dp, мм	De, мм	Df, мм	Dm, мм	Di, мм	F, мм	S, мм	R, мм	Масса, кг	
Сталь	С ребордами	18L075	TL75018	3F	F22	1108	28	54,57	53,81	60	–	–	25,0	25,0	–	0,2
		19L075	TL75019	3F	F24	1108	28	57,61	56,84	64	–	–	25,0	25,0	–	0,3
		20L075	TL75020	3F	F25	1108	28	60,64	59,88	66	–	–	25,0	25,0	–	0,3
		21L075	TL75021	3F	F26	1108	28	63,67	62,91	70	–	–	25,0	25,0	–	0,4
		22L075	TL75022	3F	F27	1108	28	66,70	65,94	75	–	–	25,0	25,0	–	0,4
		23L075	TL75023	3F	F28	1108	28	69,73	68,97	79	–	–	25,0	25,0	–	0,4
		24L075	TL75024	3F	F28	1108	28	72,77	72,00	79	–	–	25,0	25,0	–	0,5
		25L075	TL75025	3F	F29	1108	28	75,80	75,04	83	–	–	25,0	25,0	–	0,6
		26L075	TL75026	3F	F30	1108	28	78,83	78,07	87	–	–	25,0	25,0	–	0,6
		27L075	TL75027	3F	F30	1108	28	81,86	81,10	87	–	–	25,0	25,0	–	0,7
		28L075	TL75028	3F	F31	1108	28	84,89	84,13	91	–	–	25,0	25,0	–	0,7
		30L075	TL75030	3F	F33	1108	28	90,96	90,20	97	–	–	25,0	25,0	–	0,9
		32L075	TL75032	3F	F34	1108	28	97,02	96,26	102	–	–	25,0	25,0	–	1,0
		36L075	TL75036	3F	F37	1610	42	109,15	108,39	115	–	–	25,0	25,0	–	1,2
		40L075	TL75040	3F	F40	1610	42	121,28	120,51	128	–	–	25,0	25,0	–	1,7
		44L075	TL75044	3WF	F45	1610	42	133,40	132,64	142	90	110	25,0	25,0	–	2,1
48L075	TL75048	3WF	F48	1610	42	145,53	144,77	150	92	120	25,0	25,0	–	2,5		
Литейный чугун	Без реборд	60L075	TL75060	3W	–	1610	42	181,91	181,15	–	92	166	25,0	25,0	–	3,0
		72L075	TL75072	3A	–	1610	42	218,30	217,53	–	92	202	25,0	25,0	–	4,0
		84L075	TL75084	7A	–	2012	50	254,68	253,90	–	92	236	25,0	32,0	–	5,2
		96L075	TL75096	7A	–	2012	50	291,06	290,30	–	106	270	25,0	32,0	3,5	6,5
		120L075	TL75120	7A	–	2012	50	363,83	363,07	–	106	343	25,0	32,0	3,5	7,6

L 100 – 3/8" (9,525 мм)

Характеристики	Обозначение	КОД	Тип шкива	Типо-размер реборды	Втулка тапербуш	Диаметр максим. отверстия, мм	Dp, мм	De, мм	Df, мм	Dm, мм	Di, мм	F, мм	S, мм	R, мм	Масса, кг	
Сталь	С ребордами	18L100	TL10018	5F	F22	1108	28	54,57	53,81	60	–	38	31,0	22,0	9,0	0,2
		19L100	TL10019	5F	F24	1108	28	57,61	56,84	64	–	38	31,0	22,0	9,0	0,3
		20L100	TL10020	5F	F25	1108	28	60,64	59,88	66	–	45	31,0	22,0	9,0	0,4
		21L100	TL10021	5F	F26	1108	28	63,67	62,91	70	–	45	31,0	22,0	9,0	0,4
		22L100	TL10022	5F	F27	1108	28	66,70	65,94	75	–	48	31,0	22,0	9,0	0,4
		23L100	TL10023	5F	F28	1108	28	69,73	68,97	79	–	52	32,0	22,0	10,0	0,5
		24L100	TL10024	5F	F28	1108	28	72,77	72,00	79	–	52	32,0	22,0	10,0	0,6
		25L100	TL10025	5F	F29	1108	28	75,80	75,04	83	–	54	32,0	22,0	10,0	0,6
		26L100	TL10026	5F	F30	1108	28	78,83	78,07	87	–	60	32,0	22,0	10,0	0,7
		27L100	TL10027	5F	F30	1108	28	81,86	81,10	91	–	60	32,0	22,0	10,0	0,8
		28L100	TL10028	5F	F31	1108	28	84,89	84,13	91	–	65	32,0	22,0	10,0	0,8
		30L100	TL10030	5F	F33	1210	32	90,96	90,20	97	–	71	32,0	25,0	7,0	0,9
		32L100	TL10032	5F	F34	1210	32	97,02	96,26	102	–	75	32,0	25,0	7,0	1,0
		36L100	TL10036	5F	F37	1610	42	109,15	108,39	115	–	86	32,0	25,0	7,0	1,4
		40L100	TL10040	5F	F40	1610	42	121,28	120,51	128	–	96	32,0	25,0	7,0	1,7
		44L100	TL10044	5WF	F45	1610	42	133,40	132,64	142	90	110	32,0	25,0	–	2,3
48L100	TL10048	5WF	F48	1610	42	145,53	144,77	150	92	120	32,0	25,0	7,0	2,7		
Литейный чугун	Без реборд	60L100	TL10060	9W	–	1610	42	181,91	181,15	–	92	166	32,0	25,0	3,5	2,4
		72L100	TL10072	3A	–	2012	50	218,30	217,53	–	92	202	32,0	32,0	–	4,4
		84L100	TL10084	3A	–	2012	50	254,68	253,90	–	92	236	32,0	32,0	–	6,0
		96L100	TL10096	3A	–	2012	50	291,06	290,30	–	106	270	32,0	32,0	–	7,1
		120L100	TL10120	3A	–	2012	50	363,83	363,07	–	106	343	32,0	32,0	–	8,5

